



MARLA TUBE FITTINGS LTD

MTF

MARLA TUBE FITTINGS LTD
STAINLESS 316L PRESS FITTINGS & PIPE

PRESS FITTINGS & PIPE



MARLA TUBE FITTINGS LTD.

Add: Kinwarton Farm Road, Arden Forest Industrial Estate, Alcester, Warwickshire B49 6EH, U.K.

Tel: +44 (0)1789 761234

Website: <http://www.marla.co.uk>

Mail: Sales@marla.co.uk

MARLA TUBE FITTINGS LTD.

Company
Established in 1956

MARLA TUBE FITTINGS LTD



Company Information

STOCKIST OF A WIDE RANGE OF STEEL PRODUCTS.

We have progressively expanded and developed our business in line with our clients' changing needs. As well as being one of the largest wholly owned UK suppliers of fittings and flanges, we are also principal agents and distributors for leading manufacturers of our range of products in several material grades. We have our own high tech manufacturing unit covering part of our product range.

During the last decade the Marla Group has opened additional warehouses and production facilities throughout the UK, Dubai and China to provide an effective supply network. We are a "High Growth" company and have invested heavily in state of the art manufacturing facilities and computer hardware, software and associated systems, thus ensuring we remain market leaders in all areas.

At present the Marla group employs over 160 highly trained people and are committed to employing talented individuals. This ensures that we continue to meet the high standards that we have set ourselves and meet the expectations of our customers.



Approved by:      

Applications

Premium grade Stainless Steel fittings and Pipe designed for use with a wide range of applications. Some examples are below and there are many more:

- Potable water systems
- Cooling water systems
- Sprinkler systems
- Compressed Air systems
- Heating systems
- Natural gas
- Oil systems
- Biomass
- Solar thermal systems
- Inert & Industrial Gases

Characteristics & Advantages

Formed components (Fittings) conform to material specification: 316L (1.4404) UNS31603. Pipe conforms to material specification: 316L(1.4404) UNS31603.

MTF Pressfittings are quick and easy to install with low labour costs. No gluing, threading or welding required. Offers long term joint reliability and hygiene standards associated with 316L.

O-ring material options allow for a diverse range of applications.

O-ring Material(option)

Material	Colour	Working Temperature	Working Pressure
EPDM	Black	-20°C To 120°C	16 bar
HNBR	Yellow	-20°C To 100°C	Mains
FKM	Green	-20°C To 200°C	16 bar
Silicone VMQ	Blue	-40°C To 180°C	



Coupling

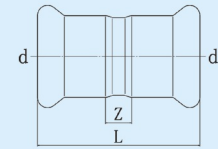
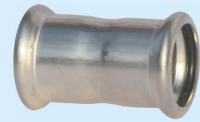

ITEM NO	Specifications	d	L	Z
UR015SH	OD15	15	48	8
UR018SH	OD18	18	48	8
UR022SH	OD22	22	50	8
UR028SH	OD28	28	54	8
UR035SH	OD35	35	62	10
UR042SH	OD42	42	71	11
UR054SH	OD54	54	83	13
UR067SH	OD66.7	66.7	127	31
UR076SH	OD76.1	76.1	141	35
UR089SH	OD88.9	88.9	162	42
UR108SH	OD108	108	194	44

Long Coupling

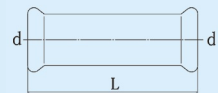

ITEM NO	Specifications	d	L
UC015SH	OD15	15	67
UC018SH	OD18	18	68
UC022SH	OD22	22	73
UC028SH	OD28	28	83
UC035SH	OD35	35	98
UC042SH	OD42	42	115
UC054SH	OD54	54	138
	OD66.7	66.7	194
	OD76.1	76.1	229
	OD88.9	88.9	263
	OD108	108	313

Reducer with Plain Ends

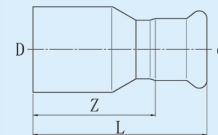

ITEM NO	Specifications	D	d	L	Z
UD018015SH	18×OD15	18	15	62	42
UD022015SH	22×OD15	22	15	62	42
UD022018SH	22×OD18	22	18	60	40
UD028015SH	28×OD15	28	15	63	43
UD028018SH	28×OD18	28	18	67	47
UD028022SH	28×OD22	28	22	66	45
	35×OD15	35	15	75	55
UD035018SH	35×OD18	35	18	78	58
UD035022SH	35×OD22	35	22	68	47
UD035028SH	35×OD28	35	28	76	53
	42×OD15	42	15	80	60
	42×OD18	42	18	80	60
UD042022SH	42×OD22	42	22	84	63
UD042028SH	42×OD28	42	28	82	59
UD042035SH	42×OD35	42	35	80	54
	54×OD15	54	15	96	76
UD054018SH	54×OD18	54	18	92	72
UD054022SH	54×OD22	54	22	96	75
UD054028SH	54×OD28	54	28	98	75
UD054035SH	54×OD35	54	35	96	70
UD054042SH	54×OD42	54	42	102	72
UD067042SH	66.7×OD42	66.7	42	131	101
UD067054SH	66.7×OD54	66.7	54	123	88
UD076042SH	76.1×OD42	76.1	42	153	123
UD076054SH	76.1×OD54	76.1	54	145	110
UD076067SH	76.1×OD66.7	76.1	66.7	142	94
UD089054SH	88.9×OD54	88.9	54	147	112
UD089067SH	88.9×OD66.7	88.9	66.7	164	116
UD089076SH	88.9×OD76.1	88.9	76.1	161	108
UD108054SH	108×OD54	108	54	162	127
UD108067SH	108×OD66.7	108	66.7	179	131
UD108076SH	108×OD76.1	108	76.1	176	123
UD108089SH	108×OD88.9	108	88.9	203	143

90° Elbow

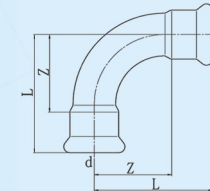

ITEM NO	Specifications	d	L	Z
UB015SH	OD15(R=1.2)	15	43	23
UB018SH	OD18(R=1.2)	18	46	26
UB022SH	OD22(R=1.2)	22	53	32
UB028SH	OD28(R=1.2)	28	64	41
UB035SH	OD35(R=1.2)	35	78	52
UB042SH	OD42(R=1.2)	42	90	60
UB054SH	OD54(R=1.2)	54	110	75
UB067SH	OD66.7(R=1.2)	66.7	137	89
UB076SH	OD76.1(R=1.2)	76.1	157	104
UB089SH	OD88.9(R=1.2)	88.9	178	118
UB108SH	OD108(R=1.2)	108	215	140

90° Elbow with Plain Ends

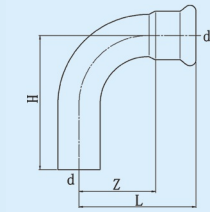

ITEM NO	Specifications	d	L	H	Z
UK015SH	OD15(R=1.2)	15	43	49	23
UK018SH	OD18(R=1.2)	18	46	52	26
UK022SH	OD22(R=1.2)	22	53	57	32
UK028SH	OD28(R=1.2)	28	64	71	41
UK035SH	OD35(R=1.2)	35	78	90	52
UK042SH	OD42(R=1.2)	42	90	102	60
UK054SH	OD54(R=1.2)	54	110	122	75
UK067SH	OD66.7(R=1.2)	66.7	137	152	89
UK076SH	OD76.1(R=1.2)	76.1	157	173	104
UK089SH	OD88.9(R=1.2)	88.9	178	199	118
UK108SH	OD108(R=1.2)	108	215	235	140

45° Elbow

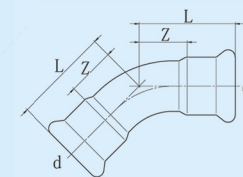

ITEM NO	Specifications	d	L	Z
UA015SH	OD15(R=1.2)	15	32	12
UA018SH	OD18(R=1.2)	18	34	14
UA022SH	OD22(R=1.2)	22	38	18
UA028SH	OD28(R=1.2)	28	42	22
UA035SH	OD35(R=1.2)	35	52	28
UA042SH	OD42(R=1.2)	42	60	30
UA054SH	OD54(R=1.2)	54	72	37
UA067SH	OD66.7(R=1.2)	66.7	90	42
UA076SH	OD76.1(R=1.2)	76.1	102	49
UA089SH	OD88.9(R=1.2)	88.9	115	55
UA108SH	OD108(R=1.2)	108	142	67

45° Elbow with Plain Ends

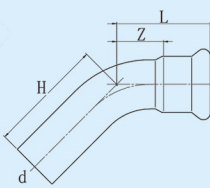

ITEM NO	Specifications	d	L	H	Z
UM015SH	OD15(R=1.2)	15	32	43	12
UM018SH	OD18(R=1.2)	18	34	48	14
UM022SH	OD22(R=1.2)	22	38	52	18
UM028SH	OD28(R=1.2)	28	42	56	22
UM035SH	OD35(R=1.2)	35	52	62	28
UM042SH	OD42(R=1.2)	42	60	72	30
UM054SH	OD54(R=1.2)	54	72	84	37
UM067SH	OD66.7(R=1.2)	66.7	90	104	42
UM076SH	OD76.1(R=1.2)	76.1	102	120	49
UM089SH	OD88.9(R=1.2)	88.9	115	134	55
UM108SH	OD108(R=1.2)	108	142	163	67



Tee

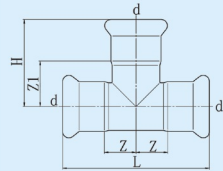

ITEM NO	Specifications	d	L	H	Z	Z1
UG015SH	OD15	15	66	39	13	19
UG018SH	OD18	18	68	40	14	20
UG022SH	OD22	22	74	44	16	23
UG028SH	OD28	28	84	52	19	29
UG035SH	OD35	35	100	57	27	31
UG042SH	OD42	42	114	66	27	36
UG054SH	OD54	54	138	77	34	42
UG067SH	OD66.7	66.7	194	99.5	49	51.5
UG076SH	OD76.1	76.1	230	111	62	58
UG089SH	OD88.9	88.9	260	128	70	68
UG108SH	OD108	108	310	156	75	81

Tee with Male Thread Ends

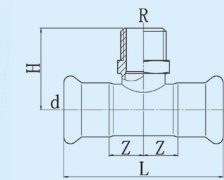

ITEM NO	Specifications	d	R	L	H	Z
UI015005SH	OD15×R1/2	15	1/2	66	36	13
	OD18×R1/2	18	1/2	68	38	14
UI022005SH	OD22×R1/2	22	1/2	74	40	16
UI022007SH	OD22×R3/4	22	3/4	74	44	16
	OD22×R1	22	1	74	47	16
UI028005SH	OD28×R1/2	28	1/2	84	43	19
UI028007SH	OD28×R3/4	28	3/4	84	47	19
UI028010SH	OD28×R1	28	1	84	50	19
	OD35×R1 1/4	35	1 1/4	100	56	24
UI042015SH	OD42×R1 1/2	42	1 1/2	114	60	27
UI054005SH	OD54×R1/2	54	1/2	138	57	34
UI054020SH	OD54×R2	54	2	138	75	34

Reducing Tee

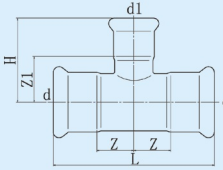

ITEM NO	Specifications	d	d1	L	Z	H	Z1
UL018015SH	OD18×OD15	18	15	68	14	38	18
UL022015SH	OD22×OD15	22	15	74	16	40	20
UL022018SH	OD22×OD18	22	18	74	16	43	22
UL028015SH	OD28×OD15	28	15	84	19	43	23
UL028018SH	OD28×OD18	28	18	84	19	46	26
UL028022SH	OD28×OD22	28	22	84	19	47	26
UL035015SH	OD35×OD15	35	15	100	24	47	27
UL035018SH	OD35×OD18	35	18	100	24	50	30
UL035022SH	OD35×OD22	35	22	100	24	51	30
UL035028SH	OD35×OD28	35	28	100	24	56	33
UL042015SH	OD42×OD15	42	15	114	27	51	31
	OD42×OD18	42	18	114	27	53	33
UL042022SH	OD42×OD22	42	22	114	27	55	34
UL042028SH	OD42×OD28	42	28	114	27	60	37
UL042035SH	OD42×OD35	42	35	114	27	61	34
UL054015SH	OD54×OD15	54	15	138	34	57	37
	OD54×OD18	54	18	138	34	59	39
UL054022SH	OD54×OD22	54	22	138	34	61	40
UL054028SH	OD54×OD28	54	28	138	34	66	43
UL054035SH	OD54×OD35	54	35	138	34	67	40
UL054042SH	OD54×OD42	54	42	138	34	71	41
UL067015SH	OD66.7×OD15	66.7	15	194	49	66.5	46.5
UL067022SH	OD66.7×OD22	66.7	22	194	49	66.5	45.5
UL067028SH	OD66.7×OD28	66.7	28	194	49	71.5	48.5
UL067035SH	OD66.7×OD35	66.7	35	194	49	72.5	46.5
UL067042SH	OD66.7×OD42	66.7	42	194	49	76.5	46.5
UL067054SH	OD66.7×OD54	66.7	54	194	49	82.5	47.5
UL076015SH	OD76.1×OD15	76.1	15	230	62	71	51
	OD76.1×OD22	76.1	22	230	62	71	50
	OD76.1×OD28	76.1	28	230	62	76	53
	OD76.1×OD35	76.1	35	230	62	77	50
	OD76.1×OD42	76.1	42	230	62	81	51
UL076054SH	OD76.1×OD54	76.1	54	230	62	87	53
UL076067SH	OD76.1×OD66.7	76.1	66.7	230	62	104	56
UL089015SH	OD88.9×OD15	88.9	15	260	70	78	58
	OD88.9×OD22	88.9	22	260	70	78	58
	OD88.9×OD28	88.9	28	260	70	83	61
	OD88.9×OD35	88.9	35	260	70	84	58
	OD88.9×OD42	88.9	42	260	70	88	58
UL089054SH	OD88.9×OD54	88.9	54	260	70	94	63
UL089067SH	OD88.9×OD66.7	88.9	66.7	260	70	110.5	62.5
UL089076SH	OD88.9×OD76.1	88.9	76.1	260	70	118	69
UL108015SH	OD108×OD15	108	15	310	80	87	67
	OD108×OD22	108	22	310	80	87	66
	OD108×OD28	108	28	310	80	92	69
	OD108×OD35	108	35	310	80	93	69
	OD108×OD42	108	42	310	80	97	67
UL108054SH	OD108×OD54	108	54	310	80	103	68
UL108067SH	OD108×OD66.7	108	66.7	310	80	120	72
UL108076SH	OD108×OD76.1	108	76.1	310	80	127	74
UL108089SH	OD108×OD88.9	108	88.9	310	80	137	77

Tee with Female Thread Ends

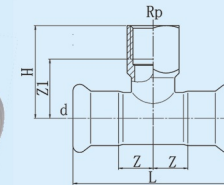

ITEM NO	Specifications	d	Rp	L	H	Z	Z1
UH015005SH	OD15×Rp1/2	15	1/2	66	38	13	24
UH018005SH	OD18×Rp1/2	18	1/2	68	41	14	27
	OD18×Rp3/4	18	3/4	68	43	14	28
UH022005SH	OD22×Rp1/2	22	1/2	74	43	16	28
UH022007SH	OD22×Rp3/4	22	3/4	74	45	16	30
UH028005SH	OD28×Rp1/2	28	1/2	84	46	19	31
UH028007SH	OD28×Rp3/4	28	3/4	84	48	19	32
UH028010SH	OD28×Rp1	28	1	84	52	19	36
UH035005SH	OD35×Rp1/2	35	1/2	100	49	24	34
	OD35×Rp3/4	35	3/4	100	50	24	36
	OD35×Rp1	35	1	100	56	24	40
UH035012SH	OD35×Rp1 1/4	35	1 1/4	100	57	24	37
UH042005SH	OD42×Rp1/2	42	1/2	114	53	27	39
	OD42×Rp3/4	42	3/4	114	55	27	39
	OD42×Rp1	42	1	114	59	27	43
UH042015SH	OD42×Rp1 1/2	42	1 1/2	114	60	27	40
UH054005SH	OD54×Rp1/2	54	1/2	138	59	34	44
	OD54×Rp3/4	54	3/4	138	61	34	45
	OD54×Rp1	54	1	138	65	34	49
UH054020SH	OD54×Rp2	54	2	138	78	34	54
UH067005SH	OD66.7×Rp1/2	66.7	1/2	194	64.5	49	49
UH067007SH	OD66.7×Rp3/4	66.7	3/4	194	67.5	49	50
	OD66.7×Rp1 1/2	66.7	1 1/2	194	72.5	49	51
UH076005SH	OD76.1×Rp1/2	76.1	1/2	230	69	62	54
UH076007SH	OD76.1×Rp3/4	76.1	3/4	230	72	62	55
UH076020SH	OD76.1×Rp2	76.1	2	230	89	62	64
UH089005SH	OD88.9×Rp1/2	88.9	1/2	260	76	70	60
UH089007SH	OD88.9×Rp3/4	88.9	3/4	260	79	70	62
UH089020SH	OD88.9×Rp2	88.9	2	260	96	70	71
UH108005SH	OD108×Rp1/2	108	1/2	310	85	80	70
UH108007SH	OD108×Rp3/4	108	3/4	310	88	80	71
UH108020SH	OD108×Rp2	108	2	310	105	80	79

90° Male Elbow

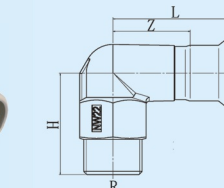

ITEM NO	Specifications	d	R	L	H	Z
	OD15×R1/2	15	1/2	55	37	35
	OD18×R1/2	18	1/2	58	39	37
	OD22×R3/4	22	3/4	61	46	39
	OD28×R1	28	1	68	54	45
	OD35×R1 1/4	35	1 1/4	76	63	50
	OD42×R1 1/2	42	1 1/2	83	67	54
	OD54×R2	54	2	94	77	59



90° Female Elbow

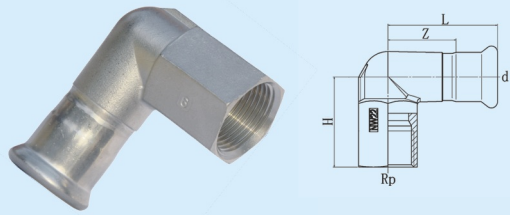

ITEM NO	Specifications	d	Rp	L	H	Z
UE015005SH	OD15×Rp1/2	15	1/2	55	37	35
UE018005SH	OD18×Rp1/2	18	1/2	58	39	37
UE022005SH	OD22×Rp1/2	22	1/2	59	39	38
UE022007SH	OD22×Rp3/4	22	3/4	61	46	39
UE022010SH	OD22×Rp1	22	1	60	54	39
UE028010SH	OD28×Rp1	28	1	68	54	45
	OD35×Rp1 1/4	35	1 1/4	76	63	50

Adaptor with Union Nut

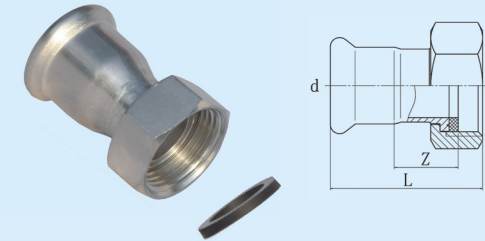

ITEM NO	Specifications	d	G	L	Z
	OD15×G1/2	15	1/2	50	18
	OD15×G3/4	15	3/4	49	18
	OD18×G1/2	18	1/2	51	18
	OD18×G3/4	18	3/4	51	20
	OD22×G1	22	1	54	21
	OD28×G1	28	1	59	24
	OD28×G1 1/4	28	1 1/4	61	26
	OD35×G1 1/2	35	1 1/2	63	25
	OD42×G1 3/4	42	1 3/4	68	25
	OD54×G2 3/8	54	2 3/8	75	24

Flange with Pressing Socket

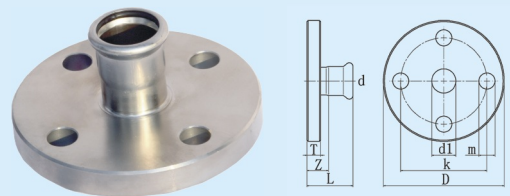

ITEM NO	Specifications	d	D	k	L	T	m	d1	Z
	OD15	15	95	65	43	11	14	14	23
	OD18	18	95	65	44	11	14	17	23
UFL022SH	OD22	22	105	75	47	12	14	21	26
UFL028SH	OD28	28	115	85	55	14	14	27	31
UFL035SH	OD35	35	140	100	64	15	18	34	36
UFL042SH	OD42	42	150	110	72	16	18	41	40
UFL054SH	OD54	54	165	125	86	18	18	53	49
UFL067SH	OD66.7	66.7	185	145	114	18	18	63.7	66
UFL076SH	OD76.1	76.1	185	145	132	18	18	72.1	76
UFL089SH	OD88.9	88.9	200	160	149	20	18	84.9	88
UFL108SH	OD108	108	220	180	172	20	18	104	98

Adaptor with Male Thread Ends

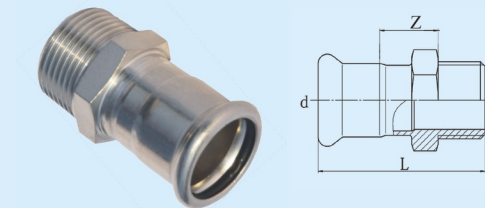

ITEM NO	Specifications	d	R	L	Z
UO015005SH	OD15×R1/2	15	1/2	54	19
UO015007SH	OD15×R3/4	15	3/4	58	20
UO018005SH	OD18×R1/2	18	1/2	54	19
UO018007SH	OD18×R3/4	18	3/4	58	24
UO022005SH	OD22×R1/2	22	1/2	56	20
UO022007SH	OD22×R3/4	22	3/4	60	23
	OD22×R1	22	1	63	23
	OD28×R3/4	28	3/4	65	25
UO028010SH	OD28×R1	28	1	68	26
	OD28×R1 1/4	28	1 1/4	70	25
	OD35×R1	35	1	69	24
UO035012SH	OD35×R1 1/4	35	1 1/4	71	24
	OD35×R1 1/2	35	1 1/2	71	24
	OD42×R1 1/4	42	1 1/4	75	28
UO042015SH	OD42×R1 1/2	42	1 1/2	75	28
	OD54×R1 1/2	54	1 1/2	84	29
UO054020SH	OD54×R2	54	2	90	28
	OD66.7×R1 1/2	66.7	1 1/2	112	34
UO067025SH	OD66.7×R2 1/2	66.7	2 1/2	112	34
UO076025SH	OD76.1×R2 1/2	76.1	2 1/2	120	35
UO089030SH	OD88.9×R3	88.9	3	133	37
UO108040SH	OD108×R4	108	4	158	42

Elbow Adaptor 90° with Male Thread Ends

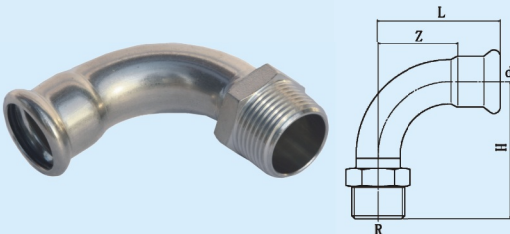

ITEM NO	Specifications	d	R	L	H	Z
UQ015005SH	OD15×R1/2	15	1/2	43	47	23
UQ018005SH	OD18×R1/2	18	1/2	46	48	26
UQ022007SH	OD22×R3/4	22	3/4	53	58	32
UQ028010SH	OD28×R1	28	1	64	69	41
UQ035012SH	OD35×R1 1/4	35	1 1/4	78	79	52
UQ042015SH	OD42×R1 1/2	42	1 1/2	90	87	60
UQ054020SH	OD54×R2	54	2	110	111	75
	OD66.7×R2 1/2	66.7	2 1/2	137	130	89

Elbow Adaptor 90° with Female Thread Ends

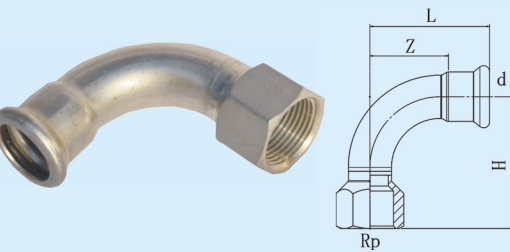

ITEM NO	Specifications	d	Rp	L	H	Z
UP015005SH	OD15×Rp1/2	15	1/2	43	45	23
UP018005SH	OD18×Rp1/2	18	1/2	46	52	26
UP022007SH	OD22×Rp3/4	22	3/4	53	57	32
UP028010SH	OD28×Rp1	28	1	64	69	41
UP035012SH	OD35×Rp1 1/4	35	1 1/4	78	80	52
UP042015SH	OD42×Rp1 1/2	42	1 1/2	90	88	60
UP054020SH	OD54×Rp2	54	2	110	115	75
	OD66.7×Rp2 1/2	66.7	2 1/2	137	127	89

Adaptor with Male Thread and Plain Ends

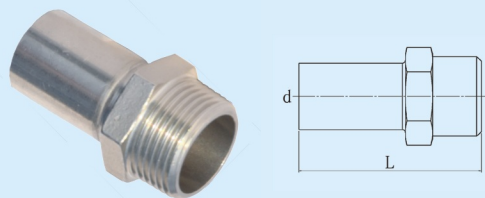

ITEM NO	Specifications	d	R	L
	OD15×R1/2	15	1/2	53
	OD18×R1/2	18	1/2	56
	OD18×R3/4	18	3/4	60
	OD22×R1/2	22	1/2	56
	OD22×R3/4	22	3/4	59
	OD22×R1	22	1	62
	OD28×R3/4	28	3/4	63
	OD28×R1	28	1	66
	OD28×R1 1/4	28	1 1/4	68
	OD35×R1 1/4	35	1 1/4	80
	OD42×R1 1/2	42	1 1/2	91
	OD54×R2	54	2	102



Adaptor with Female Thread Ends

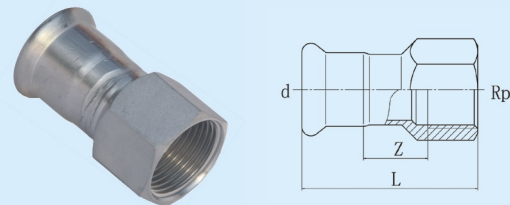

ITEM NO	Specifications	d	Rp	L	Z
UN015005SH	OD15×Rp1/2	15	1/2	55	20
UN015007SH	OD15×Rp3/4	15	3/4	59	21
UN018005SH	OD18×Rp1/2	18	1/2	58	24
UN018007SH	OD18×Rp3/4	18	3/4	60	26
UN022005SH	OD22×Rp1/2	22	1/2	58	24
UN022007SH	OD22×Rp3/4	22	3/4	61	25
	OD22×Rp1	22	1	66	26
	OD28×Rp3/4	28	3/4	64	26
UN028010SH	OD28×Rp1	28	1	70	28
	OD28×Rp1 1/4	28	1 1/4	71	26
	OD35×Rp1	35	1	66	20
UN035012SH	OD35×Rp1 1/4	35	1 1/4	72	25
	OD35×Rp1 1/2	35	1 1/2	72	25
	OD42×Rp1 1/4	42	1 1/4	70	20
UN042015SH	OD42×Rp1 1/2	42	1 1/2	76	26
	OD54×Rp1 1/2	54	1 1/2	76	21
UN054020SH	OD54×Rp2	54	2	94	34
	OD66.7×Rp2 1/2	66.7	2 1/2	109	31
	OD76.1×Rp2 1/2	76.1	2 1/2	117	38
	OD88.9×Rp3	88.9	3	130	36
	OD108×Rp4	108	4	156	41

Adaptor Union with Female Thread

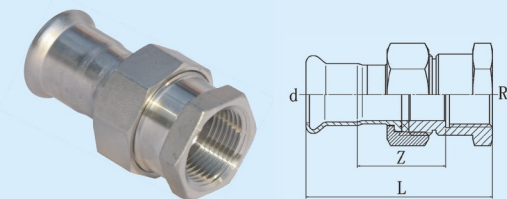

ITEM NO	Specifications	d	Rp	L	Z
UW015005SH	OD15×Rp1/2	15	1/2	73	34
	OD15×Rp3/4	15	3/4	75	38
UW018005SH	OD18×Rp1/2	18	1/2	73	36
	OD18×Rp3/4	18	3/4	76	38
UW022007SH	OD22×Rp3/4	22	3/4	81	42
UW022010SH	OD22×Rp1	22	1	83	42
UW028010SH	OD28×Rp1	28	1	88	45
UW035012SH	OD35×Rp1 1/4	35	1 1/4	95	46
UW042015SH	OD42×Rp1 1/2	42	1 1/2	101	47
UW054020SH	OD54×Rp2	54	2	109	50

Cap



ITEM NO	Specifications	d	L	Z
UF015SH	OD15	15	34	14
UF018SH	OD18	18	35	15
UF022SH	OD22	22	39	18
UF028SH	OD28	28	48	25
UF035SH	OD35	35	51	25
UF042SH	OD42	42	59	29
UF054SH	OD54	54	67	32
UF067SH	OD66.7	66.7	81	33
UF076SH	OD76.1	76.1	94	41
UF089SH	OD88.9	88.9	103	43
UF108SH	OD108	108	124	49

Adaptor Union

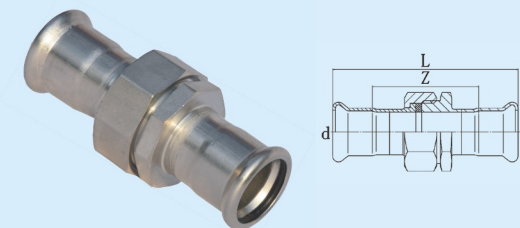

ITEM NO	Specifications	d	L	Z
US015005SH	OD15	15	89	49
	OD18	18	92	52
US022010SH	OD22	22	99	57
US028012SH	OD28	28	112	66
US035015SH	OD35	35	119	67
US042010SH	OD42	42	128	68
US054020SH	OD54	54	141	71

Adaptor Union with Male Thread

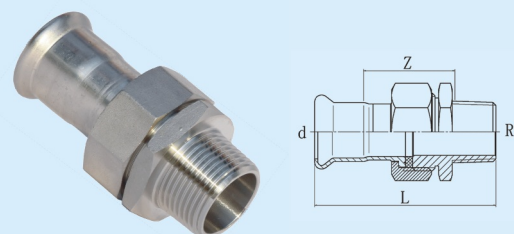

ITEM NO	Specifications	d	R	L	Z
UT015005SH	OD15×R1/2	15	1/2	73	33
	OD15×R3/4	15	3/4	76	37
UT018005SH	OD18×R1/2	18	1/2	76	37
	OD18×R3/4	18	3/4	76	37
UT022005SH	OD22×R1/2	22	1/2	78	38
UT022007SH	OD22×R3/4	22	3/4	82	43
UT022010SH	OD22×R1	22	1	86	43
UT028010SH	OD28×R1	28	1	93	49
UT035012SH	OD35×R1 1/4	35	1 1/4	102	52
UT042015SH	OD42×R1 1/2	42	1 1/2	107	53
UT054020SH	OD54×R2	54	2	118	55

3PC Press Valve

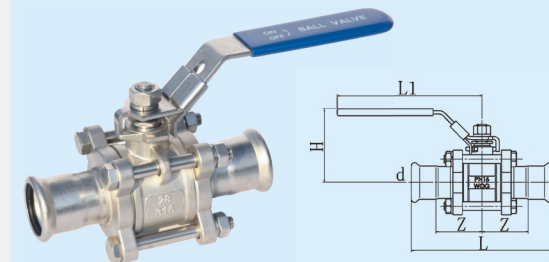

ITEM NO	Specifications	d	L	H	L1	Z
UVLV015SH	OD15	15	103	51	104	32
UVLV018SH	OD18	18	106	53	104	33
UVLV022SH	OD22	22	118	65	126	38
UVLV028SH	OD28	28	135	77	144	44
UVLV035SH	OD35	35	150	82	144	49
UVLV042SH	OD42	42	168	95	189	54
UVLV054SH	OD54	54	200	102	189	65
	OD76.1	76.1	273	119	223	84
	OD88.9	88.9	312	126	223	96
	OD108	108	369	169	298	109



RIGHT STEPS FOR THE INSTALLATION

Step 1 – cutting

Cut the pipes using suitable tools that will avoid the risk of buckling. For example, the machine oxygen cutting and the use of a disc grinding wheel are not recommended.

Step 2 – deburring

Carefully deburr the pipe, both internally and externally, as a possible residual burr could damage the O-ring and compromise the connection tightness.

Step 3 – O-ring checking

Check the correct position of the O-ring inside the toroidal chamber and lubricate it with water or soap. Do not use oil or grease at all.

Step 4 – insertion

Put the pipe into the fitting and push it through a slight rotation until it's complete stop.

Step 5 – marking

Fix the correct position between them using a marking pen in order to see possible movements before pressing.

Step 6 – providing the pressing tool

Provide the pressing tool with the suitable jaw as per the diameter of the fitting to be pressed.

Step 7 – setting pressing tool

Set the pressing tool in a correct way so that the toroidal chamber is inside the proper housing of the jaw.

Step 8 – pressing

Carry out the pressing process until the jaw-halves come in contact.

Step 9 – after pressing

Once pressed, the fitting guarantees both the stiffness of the whole system and the perfect tightness of the O-ring. Connections are now no longer divisible and resist against high stress.

PIPE DIMENSION

Specifications	OD	WT
DN12	15	0.6
DN15	18	0.7
DN20	22	0.7
DN25	28	0.8
DN32	35	1.0
DN40	42	1.1
DN50	54	1.2
	66.7	1.5
DN65	76.1	2.0
DN80	88.9	2.0
DN100	108	2.0

